

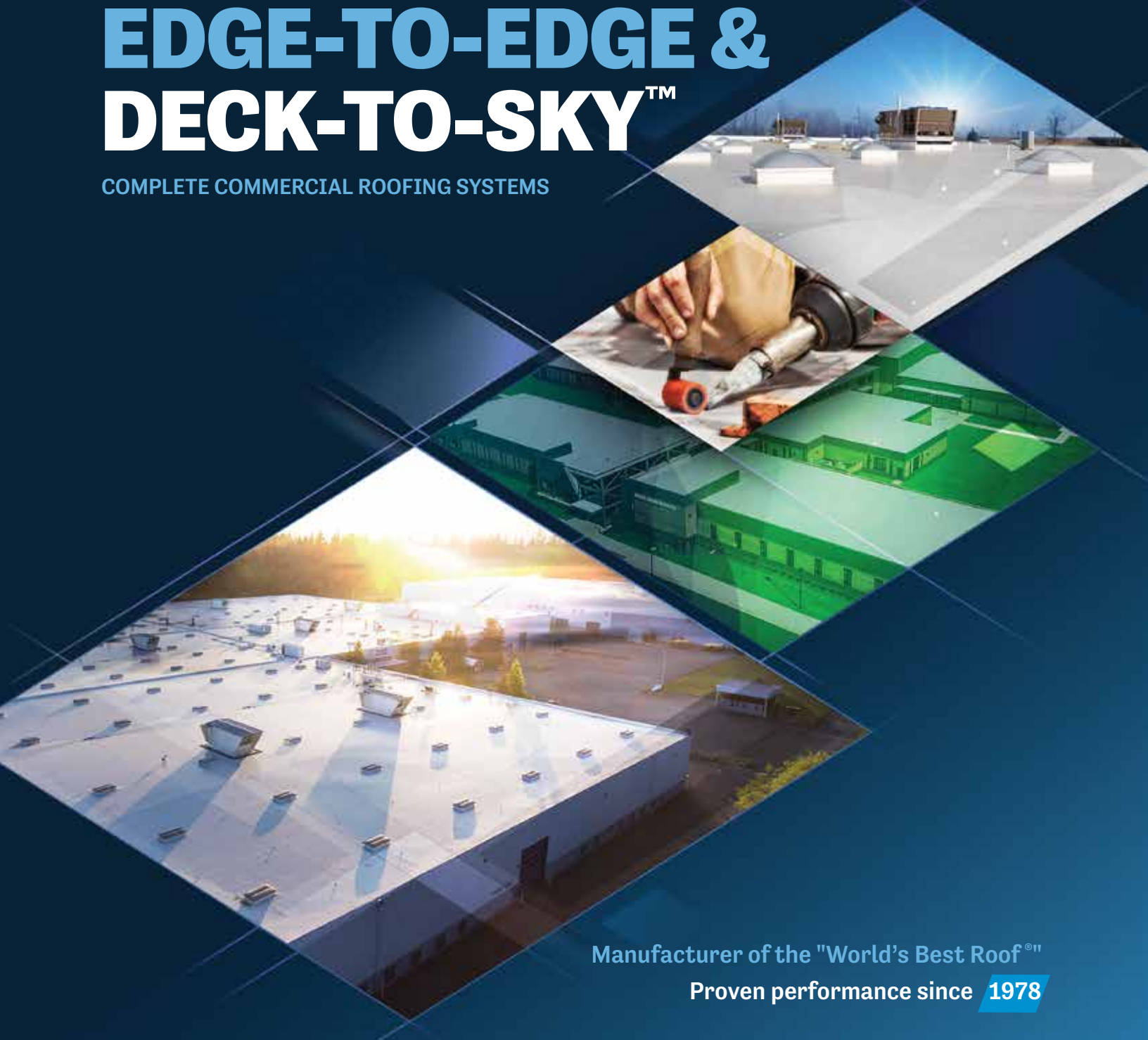

EDGE-TO-EDGE & DECK-TO-SKY™

COMPLETE COMMERCIAL ROOFING SYSTEMS



Manufacturer of the "World's Best Roof"®

Proven performance since **1978**



Building Relationships Through Partnership and Innovation

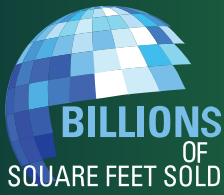

Since 1978, billions of square feet of Duro-Last® single-ply roofing have been installed throughout North America. We stand by every square foot with our best-in-class warranties, Quality Assurance department and commitment to providing problem-solving products.

Dedication

Duro-Last will do what it takes to get the job done, whether you are a roofing contractor, building owner, architect, specifier, roof consultant or engineer. We are with you – from design through post-installation inspection – to ensure the “World’s Best Roof®” is delivered.

Quality

Duro-Last is a leader in vertical integration. Since the beginning, our founder, John R Burt, strived to produce as many parts of a Duro-Last assembly in-house while also embracing the Edge-to-Edge & Deck-to-Sky approach. All of this allows Duro-Last to control quality from top to bottom.

Innovation

With entrepreneurial roots, Duro-Last cultivates a culture of innovation. We are always looking for ways to make roof systems better and solve problems for our customers.





The Duro-Last Difference

Custom-fabrication sets Duro-Last apart. Duro-Last can fabricate deck sheets and accessories to fit each building.

Custom-fabrication dramatically reduces rooftop labor – when workers are on the rooftop where the environment is harsh and unpredictable. Whether you are using custom-fabricated deck sheets or roll goods, Duro-Last's custom-fabricated flashings and accessories address the critical transition areas of a roof. All of this leads to a long-term, low-maintenance solution.

Industry Leadership

Since 1978, the Duro-Last PVC roofing membrane has proven to be durable, serviceable, flame resistant, highly flexible and recyclable. With our technologically advanced PVC extruder, we further strengthened our commitment to the proven performance of PVC roofing.

All Duro-Last roofing membranes are UL and FM approved, and many of our metal products offer ES-1 compliance. For more information on code approvals and standards, visit the Duro-Last website at duro-last.com.

Warranties

Duro-Last warranties provide unparalleled protection for virtually all commercial roofing applications. We have warranty options to suit your needs, including hail and high-wind warranties, and we were the first manufacturer to offer a warranty to expressly cover consequential damages.

North American Footprint

We are “keeping North America covered” through strategically placed Quality Assurance Technical Representatives for service and inspections, an Engineering Services Department and seven manufacturing facilities.

- **Saginaw, Michigan** - *Headquarters*
- **Carrollton, Texas**
- **Grants Pass, Oregon**
- **Jackson, Mississippi**
- **Largo, Florida**
- **Ludlow, Massachusetts**
- **Sigourney, Iowa**



Duro-Last Membrane Systems: Billions of Square Feet Installed

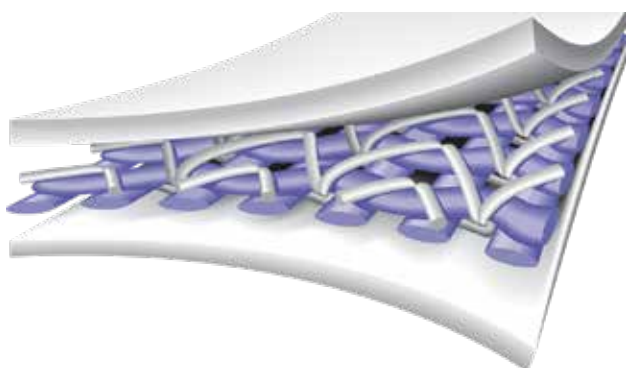

Duro-Last Custom-Fabricated System

The Duro-Last flagship membrane is a proprietary thermoplastic formulation which provides exceptional flexibility, reflectivity and resistance to UV radiation, fire and a broad range of chemicals.

A key Duro-Last difference is a weft-insertion anti-wicking scrim with a density of 18-by-14 threads per inch – giving the Duro-Last membrane its strength and durability.

- Available in 40, 50 and 60 mil thicknesses
- Colors: White, tan, gray, dark gray, terra cotta
- Only product in the marketplace to offer custom-fabrication of the entire roofing membrane
- Unique in the industry, Duro-Last offers a 15-year warranty with consequential damage coverage for commercial buildings with the Duro-Last custom-fabricated roofing system
- Can be mechanically attached, adhered or induction welded using the Duro-Bond® system

Duro-Last X™ Custom-Length Roll Goods

Our Duro-Last X membrane is manufactured via an innovative extrusion process which delivers the same proven formulation and performance as our flagship product line. Custom-cut rolls enable reduced installation labor, less waste and scrap, and fewer welds and T-patches.

- Available in 50, 60 and 80 mil thicknesses
- Smooth, white matte finish



A Difference You Can See

Fewer Welds = Fewer Leaks

- Up to 85% of seams can be completed in our factory-controlled environment
- Factory-welded seams mean better first-time quality and fewer callbacks
- Reducing on-site welding dramatically reduces potential for leaks and enables faster, quieter and easier installation
- Custom-fabricated accessories provide easier transitions, superior waterproofing and better aesthetics
- Clean installations reduce job site waste and disruptions



The Duro-Last Difference

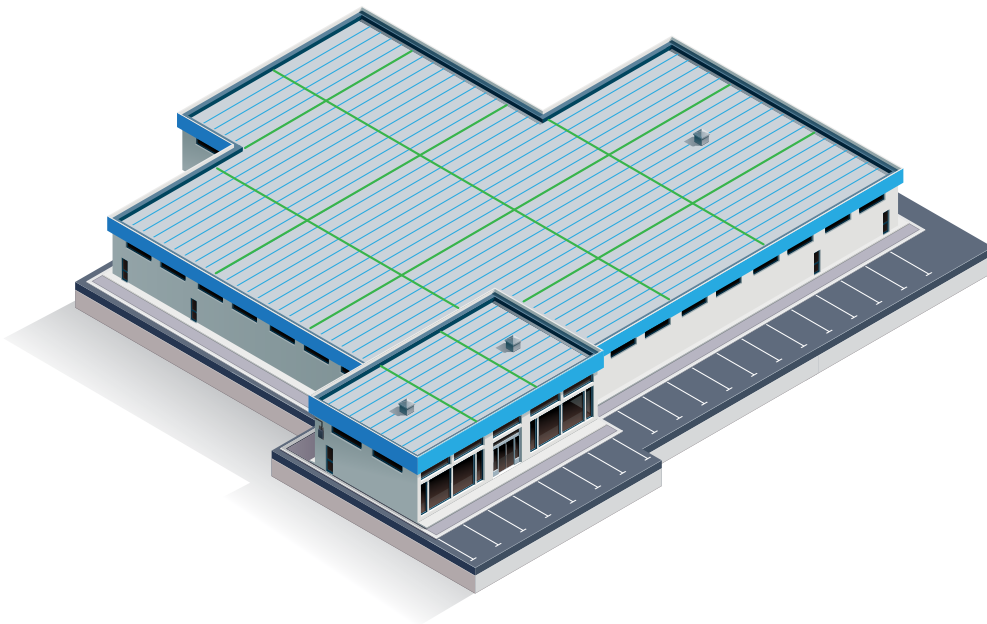

1,278

- Custom-Fabricated Duro-Last Roofing System - 5' Laps
 - Custom-Fabricated Membrane Sheets
 - Linear Feet of Field Seams - 1,278 (Green)
- (Blue lines represent Duro-Last factory seams)

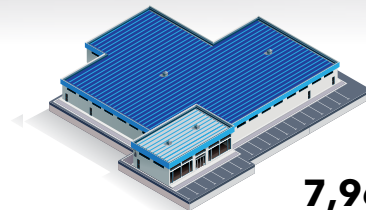

7,968

- 6' Wide Roll Good Systems
- Linear Feet of Field Seams - 7,968



5,130

- 10' Wide Roll Good Systems
- Linear Feet of Field Seams - 5,130



5,043

- 5' Wide Roll Good Systems
- Linear Feet of Field Seams - 5,043



Additional Membrane Solutions

Duro-Last also offers other PVC membrane solutions. Although we are committed to the benefits of custom-fabrication, we realize it may not be the ideal solution for all jobs and roofing contractors. Roll goods from Duro-Last enable installation on challenging roofs which are difficult to measure and projects in extreme weather.

A complete line of custom-fabricated accessories is available for each membrane product line.

Duro-Tuff®

Duro-Tuff was introduced to provide a better roll good product while also providing a cost-effective, secure and watertight installation.

- Available in 50, 60 and 80 mil thicknesses
- Roll widths: 10', 30', 5', 10'
- Can be mechanically attached, adhered or induction welded using the Duro-Bond system

Duro-Fleece®

Duro-Fleece combines a PVC thermoplastic membrane and a high-quality fleece material on the underside of the membrane. Our Duro-Fleece membranes are an ideal product for use in adhered and mechanically fastened applications over a wide variety of roof substrates.

- Available in 50, 60 and 80 mil thicknesses
- Roll widths: 5', 10'
- Can be mechanically attached or adhered

Duro-Tuff and Duro-Fleece Colors

Duro-Tuff and Duro-Fleece membranes are available in a variety of colors. These membranes have the

same color film throughout to reduce the visual effects of bleed out as well as the availability of color matched custom membrane accessories.

- Color options: blue, copper, charcoal, dark green, patina, light gray, light tan, bright red, colonial red, brown and midnight bronze
- Duro-Tuff Colors roll widths: 10', 30', 5', 10'
- Duro-Fleece Colors roll widths: 5', 10'

Duro-Last EV

Duro-Last's ketone ethylene ester (KEE) containing membrane, Duro-Last EV, offers the UV resistance, reflectivity and chemical resistance for which Duro-Last is known. Duro-Last EV contains Elvaloy™ from Dow, which provides durable flexibility in roofing membranes. Duro-Last EV is flexible and weldable in low temperatures and performs well in cold, harsh environments.

- Available in 50, 60 and 80 mil thicknesses
- Roll widths: 10', 30', 5', 10'
- Can be mechanically attached, adhered or induction welded using the Duro-Bond system

Duro-Last EV Fleece

Duro-Last EV Fleece combines high-quality fleece material on the underside of the membrane with the proven performance of the Duro-Last EV roofing membrane. Compatible with a wide variety of substrates, Duro-Last EV Fleece is an ideal solution for adhered and mechanically fastened low-slope roofing projects requiring a long lasting, energy efficient membrane.

- Available in 60 and 80 mil thicknesses
- Roll widths: 5', 10'
- Can be mechanically attached or adhered
- Features high-quality 5.5 oz. fleece material on the underside of the membrane

Above and Beyond

As a full roofing system provider, Duro-Last goes above and beyond with an extensive offering of products to protect and maintain your roof once it's installed, as well as roof coatings, pavers and retrofit solutions.

Duro-Shield® Coatings

Duro-Shield Coatings and materials can be used on a variety of substrates and are designed to help protect and revitalize the performance of commercial roofs.

Duro-Shield Silicone – A silicone-based roof coating designed to resist natural weathering while providing long-lasting watertight protection. Its brilliant white finish offers superior reflectivity and energy savings, and additional color options are available to meet a variety of aesthetic needs. When properly prepared and applied, can be used on the following roof substrates:

- Single-ply membranes (aged PVC, EPDM, TPO)
- Spray-applied polyurethane foam
- Mineral, granule-surface and smooth-surface BUR and modified bitumen
- Aged galvanized metal
- Concrete
- Wood

Duro-Shield Acrylic – A 100% elastomeric acrylic roof coating designed to seal and protect a variety of substrates with positive drainage. Its brilliant white finish reflects the sun's rays, lowering heat buildup and reducing energy costs. When properly prepared and applied, can be used on the following roof substrates:

- Single-ply membranes (PVC, EPDM, Hypalon® CSPE)
- Mineral, granule-surface and smooth-surface BUR and modified bitumen
- Metal
- Wood

Aspire Interlocking Roof Pavers

Made from up to 95% post-consumer recycled materials, the Aspire Interlocking Paver System consists of a patented grid and individual lightweight pavers to protect Duro-Last Roofing Systems or other roofing systems from damage because of excessive traffic. Offering durability with a designer look, Aspire Pavers are an ideal, low maintenance solution for rooftop patios, work areas or other high-traffic rooftop situations.

- Colors: Boardwalk, Charcoal, Ivory, Obsidian, Redwood
- Paver Sizes: 8" x 8", 4" x 8", 4" x 4" and 16" x 16"
- Lightweight and easy to handle
- Durable – crack, scratch and stain resistant
- Resilient to hail impacts
- Offers excellent slip resistance
- Patented grid system offers unique design flexibility

Duro-Last ProTerm™

Duro-Last ProTerm is pre-formed, 100% recycled PVC used to retrofit multiple types of metal wall configurations for easier installation of Duro-Last wall terminations.

- Available in three standard sizes
- Replaces the need to cut wood blocks
- Pre-applied mastic strip with release paper
- Flat termination surface

Edge-to-Edge Solutions



Protection is in the Details

Our EXCEPTIONAL Metals brand manufactures edge metal and accessories as well as drainage products. We also manufacture unique membrane-skirted products, including scuppers, conductors and collectors which are made with reinforced single-ply roofing membrane to provide unmatched strength at critical transitions.

With EXCEPTIONAL Metals edge metal products, we offer a high-quality solution for edge metal which also has an aesthetic look for a variety of roofing needs – and a majority of our edge metal products are ES-1 compliant.

Metal Roof and Wall Panels

EXCEPTIONAL Metals also offers a full line of metal roof and wall panel systems which are both aesthetically pleasing and structurally sound. With a wide range of customizable options, there is a solution for every project.

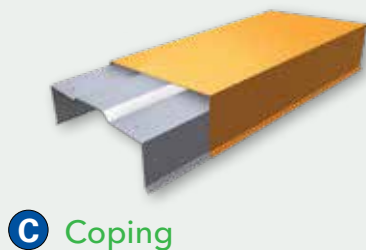
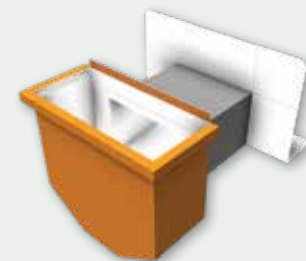
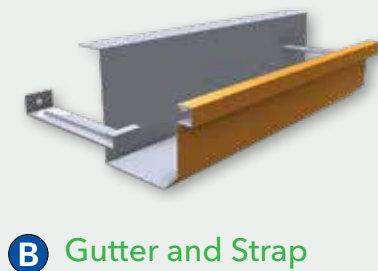
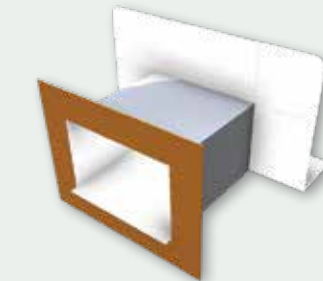

With a thick and high density lens, Duro-Light skylights get the job done at a value price with outstanding lifecycle cost benefits. Custom sizes are available.

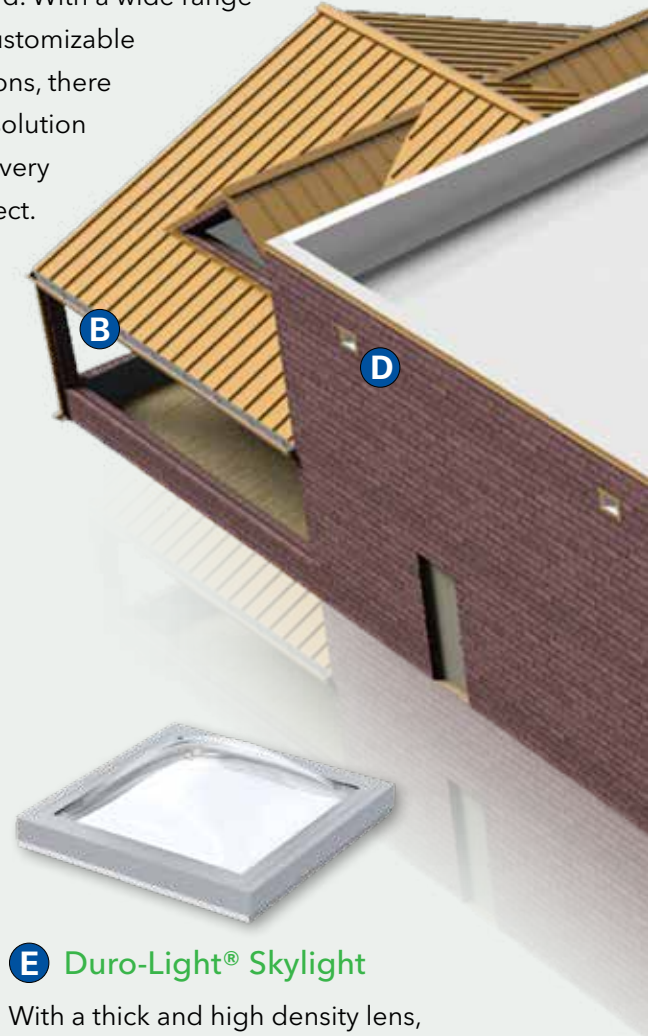

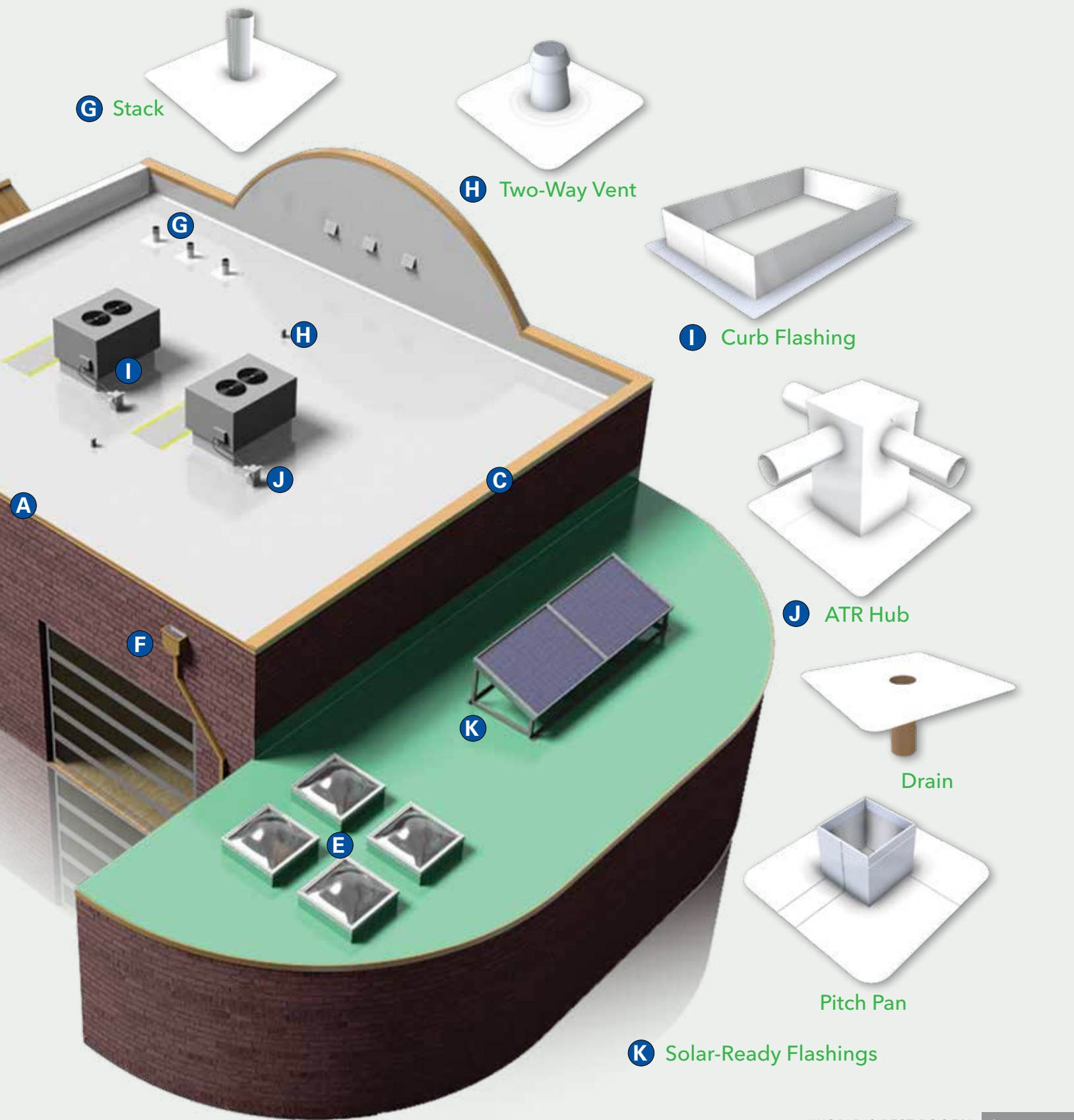

Deck-to-Sky and Installation Solutions

Increasing Efficiency

As a full roofing systems provider, Duro-Last offers many different products for fast and efficient roof installation, including:

Fasteners

TIP-TOP® Screw Manufacturing, a sister brand to Duro-Last, manufactures roofing fasteners including concrete screws, heavy-duty fasteners, construction fasteners, insulation fasteners and insulation plates for use with Duro-Last Roofing Systems and other applications.

Adhesives

For adhered applications, Duro-Last offers both solvent-based and water-based adhesives for membrane, along with low-rise foam options for insulation and cover board applications.

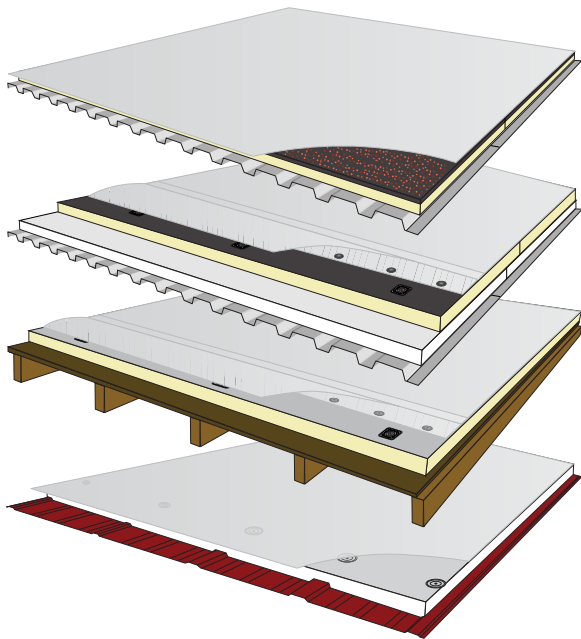

The Duro-Last Duro-Bond Roofing System

This system is a mechanically attached installation option using non-penetrating “induction weld” technology. This technique bonds the Duro-Last PVC membrane to a PVC-coated fastening plate beneath the roofing membrane, which also fastens insulation and cover board materials to the roof deck. The OMG RhinoBond® is the preferred induction fastening system.



We've Got You Covered

Duro-Last offers complete roofing systems – with solutions from Edge-to-Edge & Deck-to-Sky. Deck-to-Sky options include everything from cover boards and vapor barriers to both polyisocyanurate (ISO) and expanded polystyrene (EPS) insulation. Additionally, insulation products from Duro-Last can contribute to roofing assembly best practices and play a critical role in reducing heat exchange. Through our easy ordering process, competitive pricing and logistical service support, our Duro-Guard® line of products is both cost-effective and convenient.

Additional Duro-Guard Products Include:

- Duro-Guard EPS Flute Fill Combo
- Fan Fold
- DensDeck®, Everboard™, Securock® and DEXcell® roof boards
- Duro-Last Vapor Barrier & Torch Down Vapor Barrier

Reduce, Recycle, Reimagine

Duro-Last was Sustainable Before it was Cool

Sustainability has been a part of the Duro-Last culture for more than 20 years. Our founder, John R Burt, came up with the idea of reimagining old PVC roofs and manufacturing excess into resilient flooring, walkway pads and concrete expansion joints.

Recycling

Duro-Last has a focus on recycling at every step of the product lifecycle. In addition to our manufacturing process allowing for excess material to be recycled back into production, our custom-fabricated roof systems allow roofing contractors to reduce scrap on the job site – meaning less waste ends up in a landfill.

To date, sister brand Oscoda Plastics®, in partnership with Duro-Last, has recycled more than 100 million pounds of PVC material.

Energy

White Duro-Last Roofing Systems can greatly reduce energy consumption and electricity bills by exceeding industry standards for reflectivity and thermal emissivity.





Manufacturers of the "World's Best Roof"[®] with proven performance since 1978

Best-in-Class Warranties

Duro-Last leads the roofing industry with comprehensive warranty coverage. With our warranty groupings, we have a level of coverage right for any job.

Duro-Last Supreme Warranties

- Offer consequential damage coverage
- Available for Duro-Last, Duro-Last X and Duro-Fleece Plus membranes

Duro-Last Ultra Warranties

- Cover both material and labor
- 15- and 20-year NDH hail and/or high wind warranties

Duro-Last Basic Warranties

- 15-, 20-, 25- and 30-year NDH warranties

Duro-Last Residential Warranties

- 15- and 20-year warranties

Inspection

Upon completion of a commercial job, a Duro-Last Quality Assurance Technical Representative will inspect the Duro-Last Roofing System.

Between the inspections in our manufacturing plant and on the roof, field seams are thoroughly examined.



Spec Generator

Our Spec Generator makes it easy to specify and order Duro-Last. This online tool features the full spectrum of Duro-Last Roofing Systems along with corresponding warranties, technical data and roof details to ensure the best roofing solution for any situation.



For more information give us a call
or visit our website today.

800.248.0280

duro-last.com

Duro-Last is a division of Holcim Solutions and Products US, LLC.

"Duro-Last", the "World's Best Roof", "Duro-Guard", "Duro-Tuff", "Duro-Fleece", "Duro-Shield", "EXCEPTIONAL",

"Duro-Bond", "Duro-Light", "Oscoda Plastics" and "Tip-Top" are registered trademarks owned by Holcim Solutions and Products US, LLC.

"Edge-to-Edge & Deck-to-Sky", "Duro-Last X" and "ProTerm" are trademarks of Holcim Solutions and Building Products US, LLC.

"Hypalon" is a registered trademark owned by DuPont Performance Elastomers.

"RhinoBond" is a registered trademark owned by OMG Inc.

"DensDeck" is a registered trademark owned by Georgia-Pacific Gypsum LLC.

"Securock" is a registered trademark owned by USG Corporation.

"DEXcell" is a trademark owned by the National Gypsum Company.

"Elvaloy" is a trademark owned by The Dow Chemical Company or an affiliated company of Dow.

"Everboard" is a trademark owned by ReWall Company LLC.

Company Overview Booklet ORIG: 11.15.16 REV: 3.7.24 – DL090001

